

# PartPro200 xTCS

## All-in-One Redened

Change the way you work.  
Scan and print in full color using only one machine,  
the PartPro200 xTCS.



Full color 3D Printing



3D scanning module



## Scan and Print. In Full Color

Productivity matters. With a built-in 3D scanning module, streamline your modeling workflow. 3D scan your favorite objects, make edits to them and print directly in full color. All these using only one 3D printer.



Original object

▶ Scan 3D Model File

▶ Full Color 3D Printing



## Seamless Integration

Optimize your scans with XYZscan Color. A scanning software tool designed with a wide range of settings for the best scan results. Scan files can be exported in .obj and .stl formats, allowing for post-editing with XYZmaker or other software.



XYZscan Color



XYZmaker



OBJ

# Upgradable Laser Engraving

Bonus. The PartPro200 xTCS also has laser engraving capability. Simply swap the print head for our laser engraver add-on. Add a professional touch to your creative projects by engraving on materials such as paper, cardboard, leather, wood, and plastic.



## All New Printing Experience

Upgradable wireless connectivity and automatic print-bed correction



Magnetic easy-to-remove print bed



Easy-to-use color touch screen

Material inventory detector, allowing you to keep track of filament and stop and resume a print

Max. Print Speed  
**180**  
mm /sec

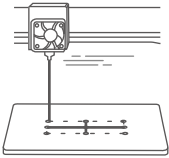

Layer Resolution  
**100 - 400**  
microns

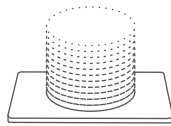

Max. Build Area (WxDxH)  
**7.9 x 7.9 x 5.9**  
inches

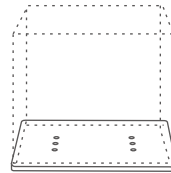

Scan Size (Ø x H)  
**2 x 2 - 5.5 x 5.5**  
inches

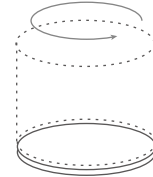

## Specifications

<b>Print Technology</b>	Color Texture Inkjet Printing 3D Structure Fused Filament Fabrication (FFF)
<b>Max. Build Area (WxDxH)</b>	Mono Color Printing : 7.9 x 7.9 x 5.9 inches (200 x 200 x 150 mm) Full Color Printing : 7.3 x 7.3 x 5.9 inches (185 x 185 x 150 mm)
<b>Layer Resolution</b>	100 - 400 microns
<b>XY Positioning Precision</b>	XY 12.5 microns
<b>Z Positioning Precision</b>	0.0004 mm
<b>Supported File Formats</b>	.amf / .ply / .obj / .stl / .3cp / .3mf
<b>Material Compatibility</b>	3D Color-inkjet PLA / PLA / Tough PLA / PETG / Antibacterial PLA / *Premium Metallic PLA / *XYZ Carbon Fiber (*Optional Extruder)
<b>Filament Diameter</b>	1.75 mm
<b>Nozzle Diameter</b>	0.4 mm
<b>Max. Moving Speed</b>	180 mm/s
<b>Print Bed</b>	Ez-removable Metal
<b>Calibration</b>	Auto
<b>Scan Technology</b>	Photogrammetry 3D

<b>Scan Size (Ø x H)</b>	2 x 2 inches - 5.5 x 5.5 inches (50 x 50 mm - 140 x 140 mm)
<b>Scan Resolution</b>	5M pixel
<b>Scan Accuracy</b>	1.48 mm
<b>Output File Types</b>	.stl / .obj
<b>Engraving Area</b>	7.9 x 7.9 inches (200 x 200 mm)
<b>Laser Wavelength</b>	450nm + 5nm/-10nm InGaN
<b>Output Power</b>	350mW ± 10%
<b>Supported Image Formats</b>	.jpg / .png / .gif / .bmp
<b>Connectivity</b>	USB 2.0 Cable/ WiFi 802.11 b/g/n / USB Flash Drive
<b>Operating Systems</b>	Windows 7 / 8 / 8.1 / 10 (64 bits) MAC OS X 10.10 / 10.11 / 10.12 / 10.13
<b>Power Requirement</b>	100V - 240V 240W
<b>Product Dimensions (WxDxH)</b>	23.6 x 22.9 x 25.2 inches (600 x 581 x 640 mm)
<b>Product Weight</b>	34 kg (75 lbs)

\* Must be upgraded to Hardened Steel Nozzle

\*\* All features and specifications are subject to change without prior notice. For more information, please visit our website at [pro.xyzprinting.com](http://pro.xyzprinting.com)